



**CITY OF CEDARBURG**  
**A MEETING OF THE PUBLIC WORKS AND SEWERAGE COMMISSION**  
**THURSDAY, FEBRUARY 12, 2026 – 7:00 PM**

A meeting of the Public Works and Sewerage Commission, City of Cedarburg, Wisconsin, will be held on Thursday, February 12, 2026 at 7:00 PM. This meeting will be held in-person, at City Hall located at W63 N645 Washington Avenue, Cedarburg, WI., lower level, Room 2.

**AGENDA**

1. CALL TO ORDER
2. ROLL CALL
  - A. Mayor Patricia Thome, Council Member Robert Simpson, AJ Hester, Charles Schumacher, Rick Verhaalen, Robert Dries, Terry Wagner, Timothy Larson, Andrew Whaley
3. STATEMENT OF PUBLIC NOTICE
4. APPROVAL OF MINUTES
  - A. November 13, 2025
  - B. December 3, 2025, Joint Common Council & Public Works Sewerage Commission meeting
5. COMMENTS AND SUGGESTIONS FROM CITIZENS
6. NEW BUSINESS
  - A. Consider changing sections of Cleveland Street, Turner Street, and Mill Street to one-way streets to allow the addition of angle parking; and action thereon.
  - B. Consider Recycling Ordinance Update; and action thereon.
  - C. Review bids received for the South Washington Avenue Reconstruction Project.
  - D. Update on the Water Recycling Center Facility Plan.
7. REPORTS
  - A. Update on Public Works operation
  - B. Update on Water Recycling Plant operations and discussion of monthly reports
  - C. Identify future agenda items

8. ADJOURNMENT

City of Cedarburg is an affirmative action and equal opportunity employer. All qualified applicants will receive consideration for employment without regard to race, color, religion, sex, disability, age, sexual orientation, gender identity, national origin, veteran status, or genetic information.

City of Cedarburg is committed to providing access, equal opportunity and reasonable accommodation for individuals with disabilities in employment, its services, programs, and activities. To request reasonable accommodation, contact the Clerk's Office, (262) 375-7606, email: [cityhall@cityofcedarburg.wi.gov](mailto:cityhall@cityofcedarburg.wi.gov).

**MEMBERS – PLEASE NOTIFY CITY CLERK'S OFFICE IF UNABLE TO ATTEND THIS MEETING.**



**CITY OF CEDARBURG**  
**Public Works and Sewerage Commission**  
**November 13, 2025**

1. CALL TO ORDER

The meeting was called to order at 7:00 p.m. by Mayor Pat Thome.

2. ROLL CALL

Present – Mayor Patricia Thome, AJ Hester, Terry Wagner, Charlie Schumacher, Bob Dries, Rick Verhaalen

Excused - CM Robert Simpson, Tim Larson

Also Present - Director of Engineering Mike Wieser, Superintendent Joel Bublitz, Superintendent Dennis Grulkowski, Administrative Assistant Theresa Hanaman

3. STATEMENT OF PUBLIC NOTICE

Administrative Assistant Theresa Hanaman confirmed that proper legal notice of the meeting had been given.

4. APPROVAL OF MINUTES

A. October 9, 2025

A motion was made by Commissioner Hester, seconded by Commissioner Schumacher, to approve the minutes of October 9, 2025. The motion carried unanimously, with CM Simpson and Commissioner Larson excused.

5. COMMENTS AND SUGGESTIONS FROM CITIZENS

None

6. NEW BUSINESS

A. Consider allowing the sump pump lateral for W61 N971 Crescent Drive to discharge to the curb & gutter through the curb face; and action thereon.

Director Wieser reported that a resident at W61 N971 Crescent Drive has requested to run their sump pump discharge under the sidewalk and through the curb face onto Crescent Drive. The discharge from their sump pump has caused ponding on their yard as well as on the sidewalk. There is no storm sewer on this section of Crescent Drive.

A motion was made by Commissioner Dries, seconded by Commissioner Wagner, to approve the sump pump lateral for W61N971 Crescent Drive to discharge to the curb and gutter through the curb face, and according to the specifications of the City Engineer. The motion carried unanimously, with CM Simpson and Commissioner

Larson excused.

B. Discuss speeding complaints on Susan Lane; and action thereon.

Director Wieser reported that the Police Department completed a speed study on Susan Lane at Kensington Avenue in September, and the average speed was 29.6 mph, and the 85th percentile speed was 34 mph. The study also showed 1.7% of vehicles were traveling at 40 mph or greater. It is often considered acceptable when the average speed is within 5 mph of the speed limit and the 85th percentile speed is within 10 mph of the speed limit. Studies have shown that crash rates decrease when the 85th percentile speed is within 10 mph of the speed limit.

Director Wieser went on to say the Police Department has increased patrols in the area. The Public Works Department has added and/or enlarged speed limit signs. Orange flags were added on the speed limit sign for eastbound traffic just east of Washington Avenue and to the speed limit sign for westbound traffic just east of Susan Court. The flags were removed from the speed limit sign just east of Susan Court at the request of a resident due to their appearance. Signs that state "Radar Enforced" are on order and will be added to two of the speed limit signs.

Commissioners discussed the location and description of signage, the division of roadways between the City and the Town, and the necessary steps for enforcement.

Commissioner Hester suggested postponing the discussion, emphasizing the importance of observing the recent changes before proceeding further.

C. Update on the Adaptive Management Plan.

Superintendent Grulkowski reported that last year, the Cedar Creek Farmers removed a total of 1,972.8 pounds of material. This year, they increased this amount to 3,234.9 pounds, resulting in a gain of 1,300 pounds. Jon Butt from Mead and Hunt will give a presentation to the Public Works and Sewerage Commission about the decrease in phosphorus levels at the confluence of Cedar Creek and the Milwaukee River, which is the ultimate goal. Moving forward, the WRC plans to add 2 more farms in the 2025-2026 period, bringing the total to 13 farms.

## 7. REPORTS

A. Update on Public Works operations

Superintendent Joel Bublitz provided an update to the Commission regarding the Department of Public Works (DPW). They are currently clearing areas for Procknow to conduct drilling for test wells. Two crews have been working on leaf collection. A mechanic has recently been hired, and the search for a crew member is still ongoing.

B. Update on Water Recycling Plant operations and discussion of monthly reports

Superintendent Grulkowski reported that the ditch project has been completed and is functioning well. The WRC replaced the flow meter with RAS pumps; however, the flow meter at the Garfield Station has not yet been installed and is scheduled for next week.

Additionally, there will be a joint meeting on December 3rd, and there has been considerable interest and inquiries regarding this meeting.

C. Identify future agenda items

None

8. ADJOURNMENT

A motion was made by Commissioner Hester, seconded by Commissioner Verhaalen, to adjourn the meeting at 7:28 p.m. The motion carried unanimously, with CM Simpson and Commissioner Larson excused.

Theresa Hanaman  
Engineering Administrative Assistant

[MIN\_SIGNATURES]



**CITY OF CEDARBURG**  
**Joint Common Council & Public Works & Sewerage**  
**December 3, 2025**  
**Minutes**

1. CALL TO ORDER

Mayor Thome called the meeting to order at 7:05 p.m.

2. ROLL CALL

- A. Present for Council: Mayor Patricia Thome, Council Members Melissa Bitter, Kristin Burkart (Zoom), Amanda Didier, Robert Simpson (7:09 pm), Kristian Lindo (Zoom), Mark Mueller  
Excused: Council Member Jim Fitzpatrick

Present for Public Works & Sewerage Commission: Mayor Patricia Thome, Council Member Robert Simpson (7:09 pm), Andrew Whaley, Charles Schumacher, Rick Verhaalen, Robert Dries, Terry Wagner  
Excused: Andrew Hester, Tim Larson

3. MOMENT OF SILENCE

4. PLEDGE OF ALLEGIANCE

5. STATEMENT OF PUBLIC NOTICE

At Mayor Thome's request, City Clerk Sette verified that notice of this meeting was posted in accordance with the Wisconsin Open Meetings Law.

6. COMMENTS AND SUGGESTIONS FROM CITIZENS

None

7. PRESENTATIONS

Nathan Cassity of Donohue & Associates summarized the Water Recycling Center facility plan, which contained four options for repairing and renovating the Water Recycling Center. The full facility plan may be found on the City website.

## 8. PUBLIC HEARING

- A. A Public Hearing to consider a new Water Recycling Center Facility Plan which includes upgrading and expanding the current facilities located at W54 N370 Park Lane, Cedarburg, WI.

Mayor Thome opened the Public Hearing, inviting comments from the public.

Karsten Huse from Light & Water suggested a formal rate study be completed.

Terry King: W63 N762 Sheboygan Rd - asked if a lower population growth could affect total cost.

Laura VanGenderen: N31 W5100 Landmark Dr - expressed concerns with cost overages

A discussion ensued between Common Council members and Public Works & Sewerage Commission members regarding project time-line, cost beyond 20 years, and future sewer rates.

A motion was made by Council Member Didier, seconded by Council Member Mueller for the Council, and a motion was made by Commissioner Verhaalen, seconded by Commissioner Simpson for the Public Works & Sewerage Commission to close the public hearing at 8:24 p.m. Motion carried on a roll call vote with Council Members Bitter, Burkart, Didier, Simpson, Lindo, and Mueller voting aye and Council Member Fitzpatrick excused, and Commissioners Thome, Simpson, Whaley, Schumacher, Verhaalen, Dries, and Wagner voting aye for the Public Works & Sewerage Commission and Commissioner Hester excused.

## 9. NEW BUSINESS

- A. Discussion and possible action to approve and submit the Water Recycling Facility Plan to the DNR

A discussion ensued highlighting the need for additional DNR approval should there be any changes to treatment processes.

A motion was made by Commissioner Verhaalen, seconded by Commissioner Simpson, to recommend to the Common Council alternative #1 for renovating the Water Recycling Center. Motion carried without a negative vote with Commissioner Hester excused.

Council Member Bitter recommended the Council review a financial analysis of the project that would extend beyond the 20-year DNR requirement.

A motion was made by Council Member Simpson, seconded by Council Member Mueller, to approve and submit the Water Recycling Facility Plan to the Wisconsin

DNR for plan alternative #1. Motion carried with one negative vote from Council Member Bitter, and Council Member Fitzpatrick excused.

- B. Discussion and possible action on repairs to oxidation ditch aeration trains at the existing Water Recycling Center.

Water Recycling Superintendent Dennis Grulkowski explained that two (2) of the six (6) trains have been rebuilt this year. The request tonight is for funding to rebuild two (2) more next year.

A motion was made by Commissioner Dries, seconded by Commissioner Simpson, to recommend to the Common Council repairs to the oxidation ditch aeration trains not to exceed \$331,906. Motion carried without a negative vote with Commissioner Hester excused.

A motion was made by Council Member Simpson, seconded by Council Member Bitter, to approve repairs to the oxidation ditch aeration trains not to exceed \$331,906. Motion carried with Council Member Fitzpatrick excused.

## 10. ADJOURNMENT

A motion was made by Mayor Thome, seconded by Commissioner Simpson for the Public Works & Sewerage Commission, and a motion was made by Council Member Mueller, seconded by Council Member Didier for the Common Council, to adjourn the meeting at 8:36 p.m. Motion carried without a negative vote with Council Member Fitzpatrick and Commissioner Hester excused.

[MIN\_SIGNATURES]

**CITY OF CEDARBURG**

**MEETING DATE:** February 12, 2026

**ITEM NO:** A.

**TITLE:**

Consider changing sections of Cleveland Street, Turner Street, and Mill Street to one-way streets to allow the addition of angle parking; and action thereon.

**ISSUE SUMMARY:**

The Economic Development board is attempting to gain more parking in the downtown area.

One of their ideas is to change a portion of 3 streets to one-way traffic and add angle parking where possible on one side. The streets they are proposing to make one-way streets are as follows:

1. Cleveland Street (Washington to Hanover) – westbound traffic only
2. Turner Street – eastbound traffic only
3. Mill Street (Washington to Hanover) westbound traffic only

Attached are some exhibits showing what this would look like. The change to Cleveland Street would add parallel parking on both sides with one westbound driving lane. The change to Turner Street would add angle parking on the south side and parallel parking on the north side with one eastbound driving lane. The change to Mill would add angle parking on either the north or south side and parallel parking on the other side with one westbound driving lane. The Cleveland change would add 7 spaces, the Turner change would add 8 spaces, and the Mill change would add 7-8 spaces for a grand total of 22-23 additional parking spaces.

**STAFF RECOMMENDATION:**

**BOARD, COMMISSION OR COMMITTEE RECOMMENDATION:**

**BUDGETARY IMPACT:**

**ATTACHMENTS:**

1. One Way Streets

**INITIATED/REQUESTED BY:**

Mike Wieser

**FOR MORE INFORMATION CONTACT:**

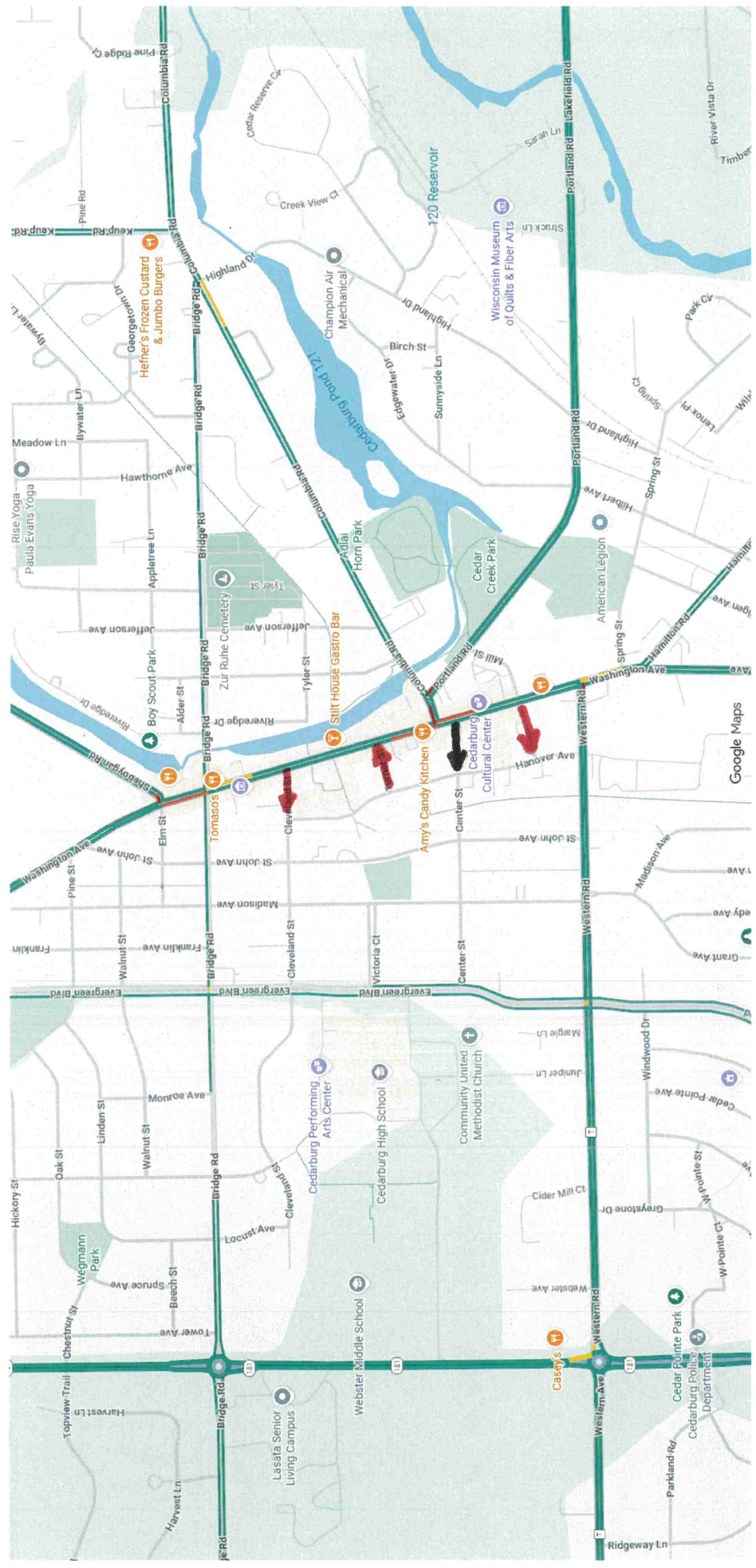

→ **PROPOSED ONE-WAY**

→ **EXISTING ONE-WAY**

TOR SHALL REMOVE ASPHALT, NECESSARY SUBGRADE TO PTH IN FULL PAVEMENT N LIMITS (WASHINGTON AVE. BLVD.)

NOTE: NEW CATCH BASINS SHALL BE 24" x 36" WITH 2' SUMPS WITH R-3067 FRAMES.

Cleveland St  
(Proposed Westbound Only from Washington to Hanover)

Two Way ← → One Way

FULL PAVEMENT & BASE COURSE REPLACEMENT (TYP)

BM #6  
RR SPIKE ON POWER POLE  
#3113  
STA 73+57.14' LT  
ELEV. = 796.39

EX. CONCRETE ROADWAY

WASHINGTON AVE.

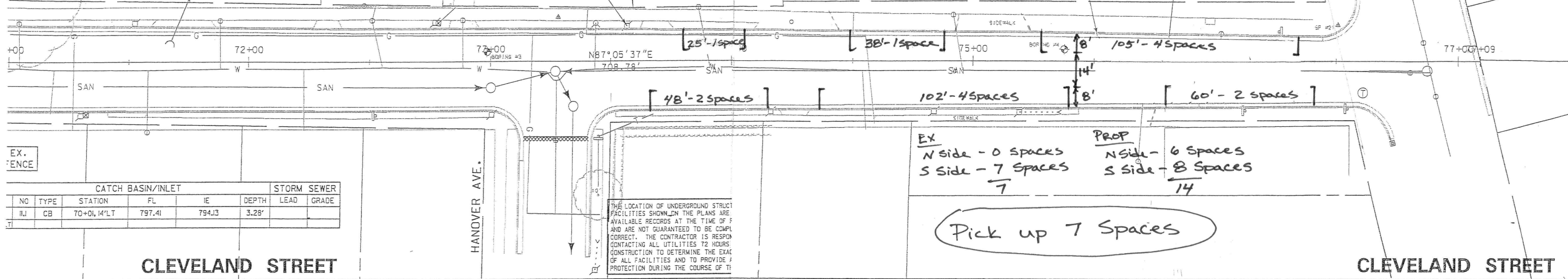

EX  
N Side - 0 Spaces  
S Side - 7 Spaces  
7

PROP  
N Side - 6 Spaces  
S Side - 8 Spaces  
14

Pick up 7 Spaces

THE LOCATION OF UNDERGROUND STRUCTURE FACILITIES SHOWN ON THE PLANS ARE AVAILABLE RECORDS AT THE TIME OF PREPARATION AND ARE NOT GUARANTEED TO BE COMPLETELY CORRECT. THE CONTRACTOR IS RESPONSIBLE FOR CONTACTING ALL UTILITIES 72 HOURS BEFORE CONSTRUCTION TO DETERMINE THE EXACT LOCATION OF ALL FACILITIES AND TO PROVIDE PROTECTION DURING THE COURSE OF THE WORK.

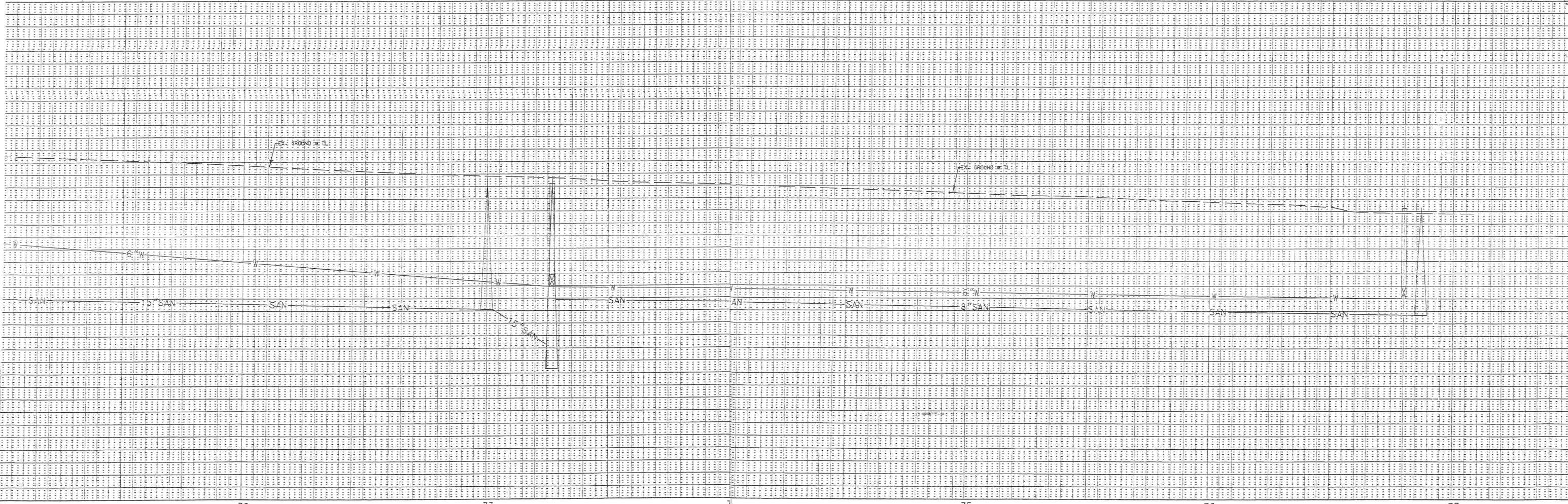

**SPELL-SNYDER, INC.**  
PROFESSIONAL CONSULTANTS  
2621348-5600 Madison 6081244-6277 Milwaukee Regional 2621250-8000  
Racine 2621554-8530 Fox Valley 7151752-4620

**2008 STREET & UTILITY PROJECTS**  
**CONTRACT # 2008-01**  
**CITY OF CEDARBURG**  
**OZAUKEE COUNTY, WI**

PROJECT NO	REVISIONS	BY	DATE
RO7-07			
SHEET NO.			
9			
FILE NO.			
F-2			

VERIFY SCALES	DRAWN BY:	DESIGNED BY:
BAR IS ONE INCH ON ORIGINAL DRAWING.	PRELIM B.G.	M. WIESER
IF NOT ONE INCH ON THIS SHEET, ADJUST SCALES ACCORDINGLY.	FINAL D.R.	CHECKED BY T. HARTJES
	DATE APRIL, 2008	SCALE HORZ: 1"=20' VERT: 1"=4'

**CRISPELL-SNYDER**  
PROFESSIONAL CO  
Lake Geneva 2621348-5600 Madison 6081244-6277  
Racine 2621554-8530 Fox Valley

# Turner St (Angle Parking South)

(Proposed Eastbound Only from Washington to Hanover)

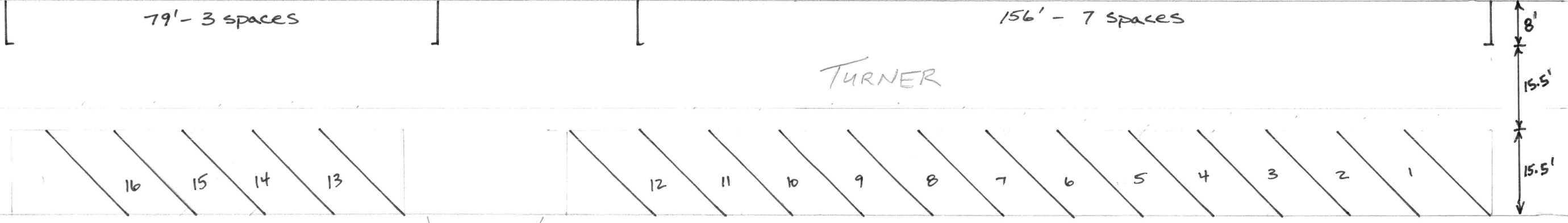

45° Angle Parking  
Stalls 9' x 22'

<u>Ex</u>	<u>Prop</u>
Nside - 10 Spaces	Nside - 10 Spaces
Sside - 8 Spaces	Sside - 16 Spaces
<hr style="width: 50px; margin-left: 0;"/>	
18 Spaces	26 Spaces

Pick up 8 Spaces

24/05/99 Time 13:55 DIMSCALE: 1" = 20'

# Mill St (Angle Parking South Option) (Proposed Westbound Only from Washington to Hanover)

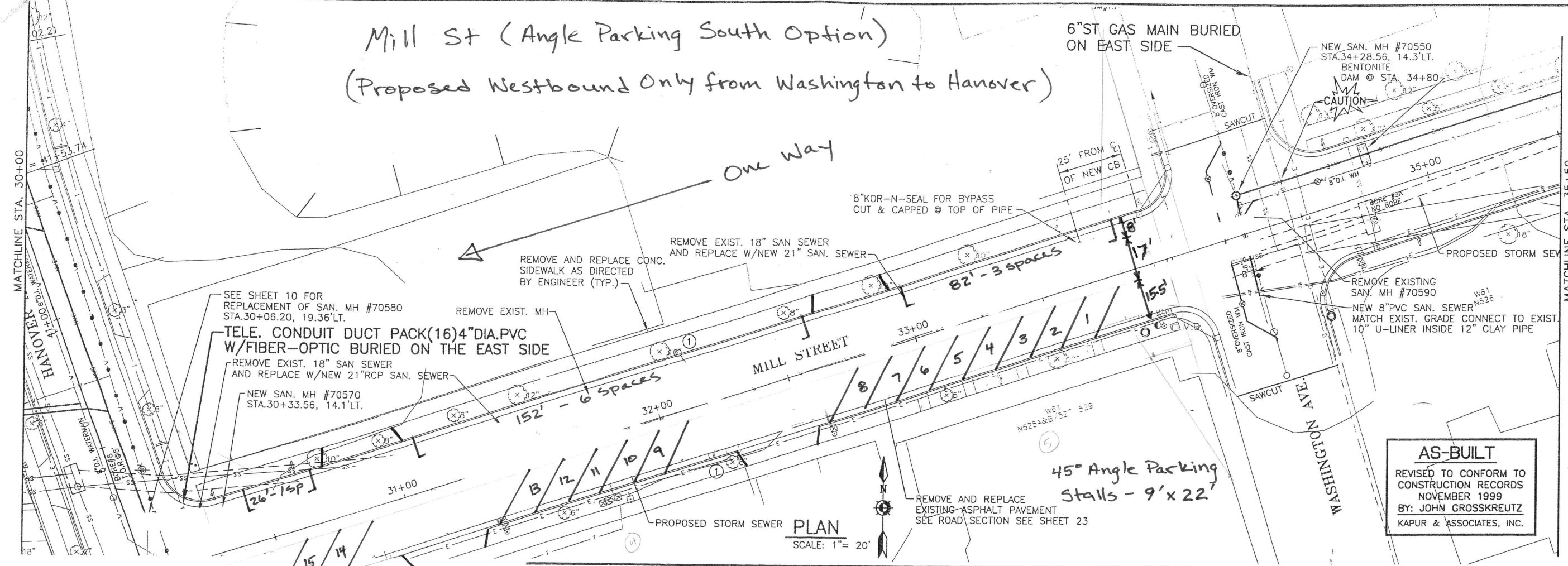

Ex  
N Side - 9 Spaces  
S Side - 9 Spaces  
18

PROP  
N Side - 10 Spaces  
S Side - 15 Spaces  
25

Pick up 7 Spaces

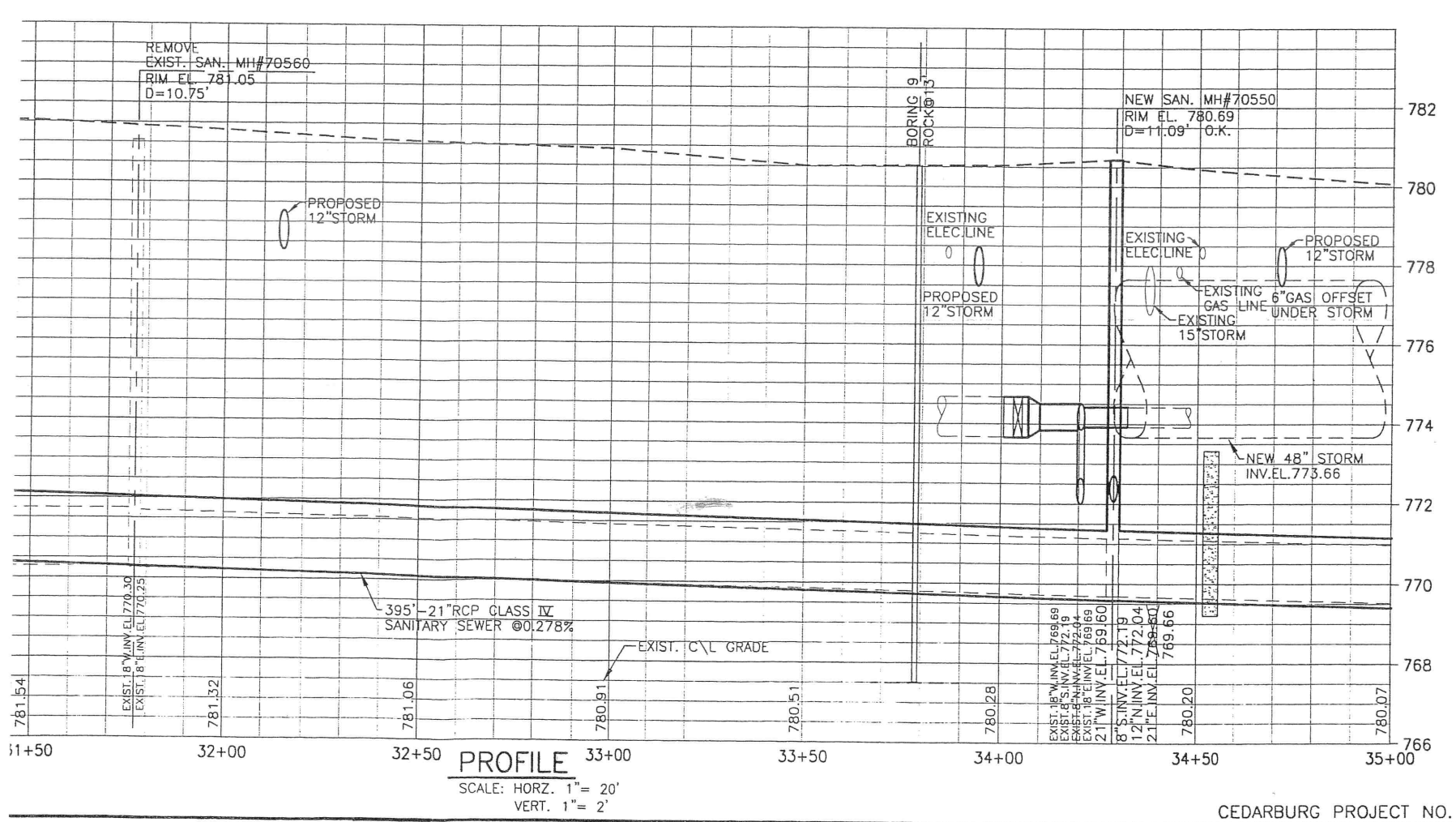

NO.	DATE	REVISIONS

DESIGNED BY:	T.R.W.	NO.

VERIFY SCALES	SCALE
BAR ON ORIGINAL DRAWING IS ONE INCH	1
IF NOT ONE INCH ADJUST SCALES ACCORDINGLY	

  

PROJECT NO. 98828.201  
SHEET NO. 11

KAPUR & ASSOCIATES, INC.  
CONSULTING ENGINEERS  
MILWAUKEE, WISCONSIN  
(414) 351-6668  
FAX 414-351-4117

1999 STREET AND UTILITY PROJECTS  
MILL STREET STA. 30+00 TO 35+00  
CEDARBURG, WISCONSIN

Mill St (Angle Parking North Option)  
 (Proposed Westbound Only from Washington to Hanover)

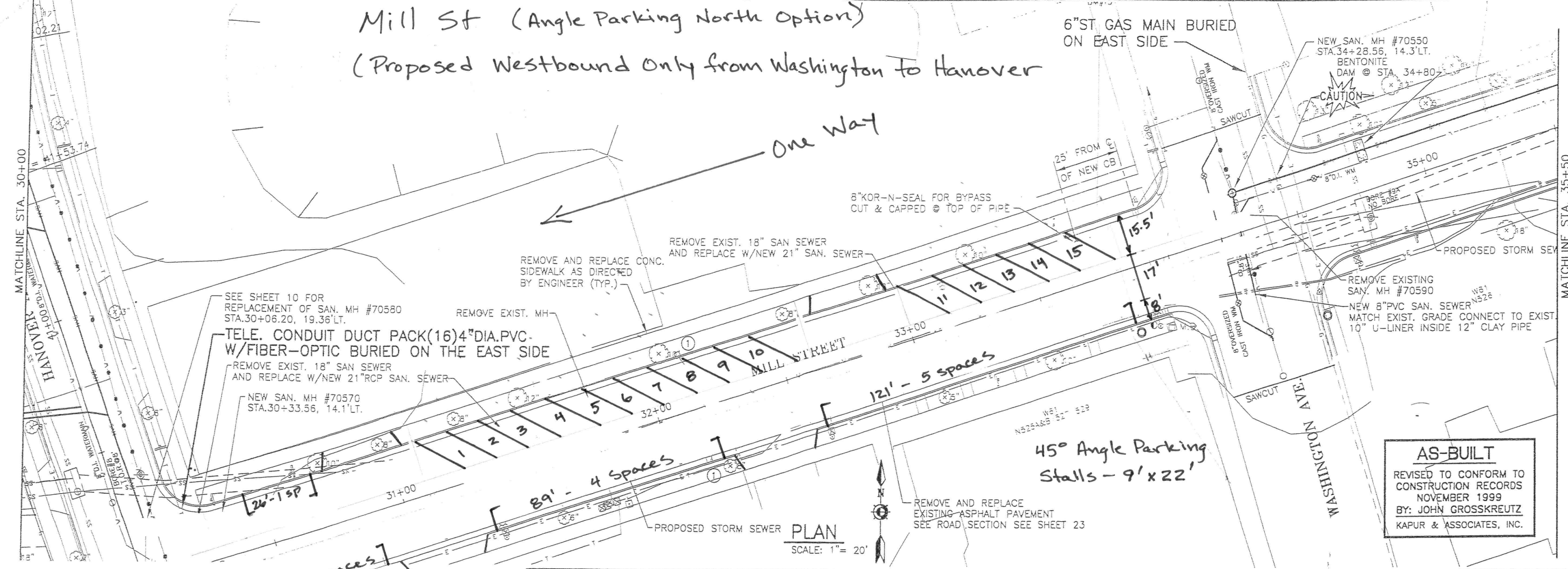

Ex      Prop

N side - 9 spaces      N side - 11 spaces

S side - 9 spaces      S side - 15 spaces

   18 spaces      26 spaces

Pick up 8 spaces

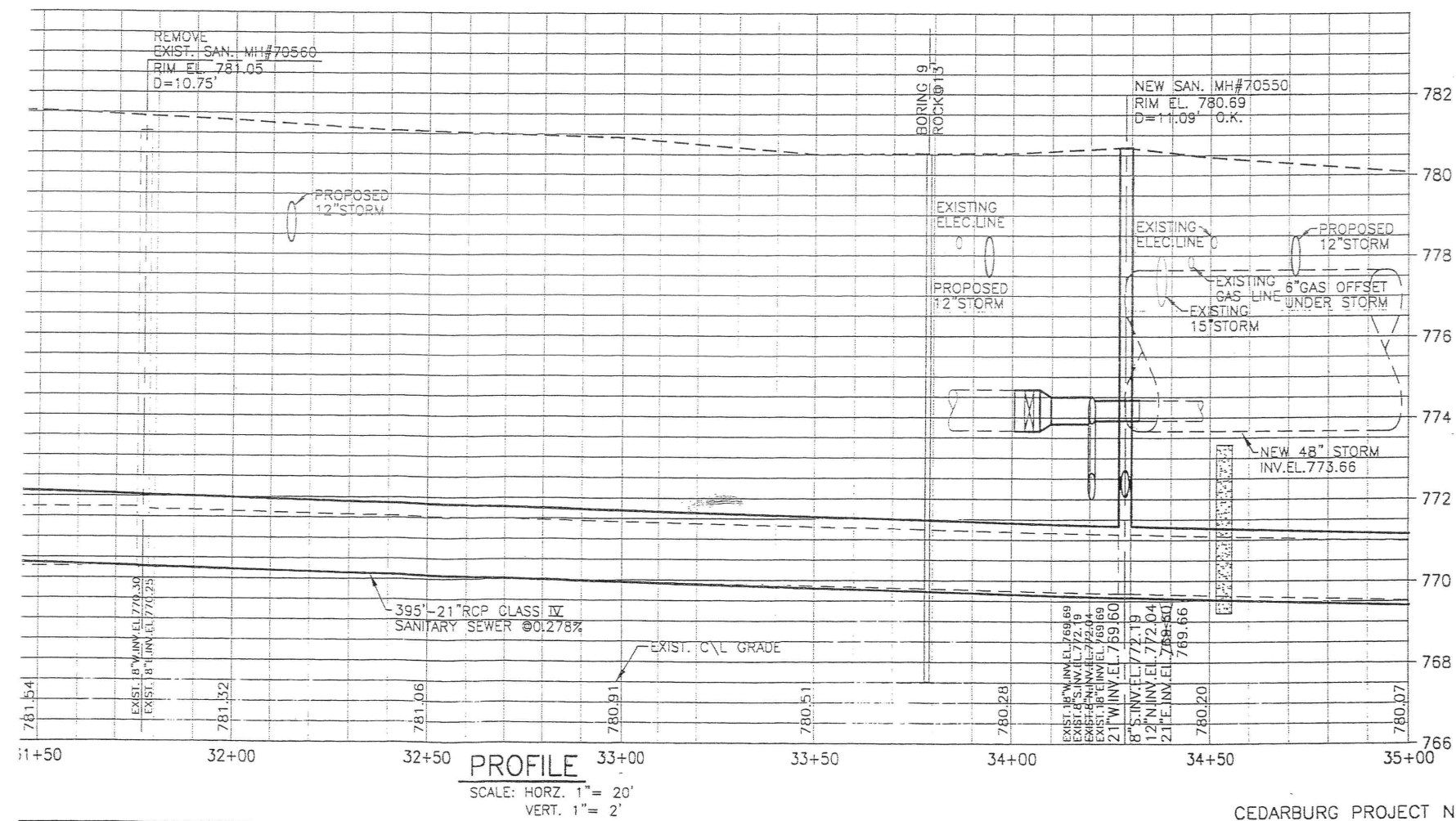

**AS-BUILT**  
 REVISED TO CONFORM TO CONSTRUCTION RECORDS NOVEMBER 1999  
 BY: JOHN GROSSKREUTZ  
 KAPUR & ASSOCIATES, INC.

DESIGNED BY: T.R.W.	NO.	DATE
DRAWN BY: J.J.G.	REVISIONS	
CHECKED BY: T.R.W.		
APPROVED BY: R.K.		
DATE: 2/25/99		
SCALE: 1" = 20'		

VERIFY SCALES  
 BAR ON ORIGINAL DRAWING IS ONE INCH IF NOT ONE INCH ADJUST SCALES ACCORDINGLY

KAPUR & ASSOCIATES, INC.  
 CONSULTING ENGINEERS  
 MILWAUKEE, WISCONSIN  
 (414) 351-6668  
 FAX 414-351-4117

**K&A**

1999 STREET AND UTILITY PROJECTS  
 MILL STREET STA. 30+00 TO 35+00  
 CEDARBURG, WISCONSIN

PROJECT NO. 98828.201  
 SHEET NO. 11

**CITY OF CEDARBURG**

**MEETING DATE:** February 12, 2026

**ITEM NO:** B.

**TITLE:**

Consider Recycling Ordinance Update; and action thereon.

**ISSUE SUMMARY:**

The WDNR is requiring the City to pass an ordinance to reflect changes made by the recycling rule revision. This is required for the City to continue being eligible for the recycling grant received annually totaling around \$37,000.

**STAFF RECOMMENDATION:**

**BOARD, COMMISSION OR COMMITTEE RECOMMENDATION:**

**BUDGETARY IMPACT:**

**ATTACHMENTS:**

1. Ord 2026-XX Recycling-revised draft-sec 8-3-13

**INITIATED/REQUESTED BY:**

Mike Wieser

**FOR MORE INFORMATION CONTACT:**

## ORDINANCE NO. 2026-XX

### An Ordinance to amend Section 8-3-13 of City Code Relating to the City's Recycling Program

The Common Council of the City of Cedarburg, Wisconsin, does ordain as follows:

**SECTION 1.** Section 8-3-13(f)(1) through (26) of the Code of Ordinances of the City of Cedarburg is hereby repealed and recreated as follows:

(f) *Definitions. For the purposes of this ordinance*

- 1) *Bi-metal container* means a container for carbonated or malt beverages that is made primarily of a combination of steel and aluminum.
- 2) *Container board* means corrugated paperboard used in the manufacture of shipping containers and related products.
- 3) *Foam polystyrene packaging* means packaging made primarily from foam polystyrene that satisfies one of the following criteria:
  - a) Is designed for serving food or beverages.
  - b) Consists of loose particles intended to fill space and cushion the packaged article in a shipping container.
  - c) Consists of rigid materials shaped to hold and cushion the packaged article in a shipping container.
- 4) *Glass Container* means a glass bottle, jar or other packaging container used to contain a product that is the subject of a retail sale and does not include ceramic cups, dishes, oven ware, plate glass, safety and window glass, heat-resistant glass such as pyrex, lead based glass such as crystal, or TV tubes.
- 5) *HDPE* means high density polyethylene, labeled by the resin code # 2.
- 6) *LDPE* means low density polyethylene, labeled by the resin code # 4.
- 7) *Magazines* means magazines and other materials printed on similar paper.
- 8) *Major appliance* means a residential or commercial air conditioner, clothes dryer, clothes washer, dishwasher, freezer, microwave oven, oven, refrigerator, furnace, boiler, dehumidifier, water heater or stove.
- 9) *Multiple-family dwelling* means a structure containing 5 or more residential units, including units that are occupied seasonally.
- 10) *Newspaper* means a newspaper and other materials printed on newsprint.
- 11) *Non-residential facilities and properties* means commercial, retail, industrial, institutional and government facilities and properties. Non-residential facilities and properties includes any location at which goods or services are provided or manufactured, including locations under construction, demolition, or remodeling, or used for special events such as fairs, festivals, sport venues, conferences, and exhibits. This term does not include multiple family dwellings.
- 12) *Office paper* means a variety of high-grade printing and writing papers. This term does not include industrial process waste, newspaper or packaging.
- 13) *Other resins or multiple resins* mean plastic resins labeled by the resin code # 7.

- 14) *Person* includes any individual, corporation, limited liability company, partnership, association, local government unit, as defined in s. 66.0131(1)(a), Wis. Stats., state agency or authority or federal agency.
- 15) *PETE* or *PET* means polyethylene terephthalate, labeled by the resin code # 1.
- 16) *Plastic container* means an individual, separate, rigid plastic bottle, can, jar or carton, except for a blister pack, that is originally used to contain a product that is the subject of a retail sale.
- 17) *Postconsumer waste* means solid waste other than solid waste generated in the production of goods, hazardous waste, as defined in s. 291.01(7) Wis. Stats., waste from construction and demolition of structures, scrap automobiles, or high-volume industrial waste, as defined in s. 289.01(17)., Wis. Stats.
- 18) *PP* means polypropylene, labeled by the resin code # 5.
- 19) *PS* means polystyrene, labeled by the resin code # 6.
- 20) *PVC* means polyvinyl chloride, labeled by the resin code # 3.
- 21) *Recyclable materials* includes lead acid batteries; major appliances; waste oil; yard waste; aluminum containers; corrugated paper or other container board; foam polystyrene packaging; glass containers; magazines; newspaper; office paper; rigid plastic containers, including those made of PETE, HDPE, PVC, LDPE, PP, PS and other resins or multiple resins; steel containers; waste tires; and bi-metal containers.
- 22) *Solid waste* has the meaning specified in [s. 289.01\(33\), Wis. Stats.](#)
- 23) *Solid waste facility* has the meaning specified in [s. 289.01\(35\), Wis. Stats.](#)
- 24) *Solid waste treatment* means any method, technique or process which is designed to change the physical, chemical or biological character or composition of solid waste. Treatment includes incineration.
- 25) *Waste tire* means a tire that is no longer suitable for its original purpose because of wear, damage or defect.
- 26) *Yard waste* means leaves, grass clippings, yard and garden debris and brush, including clean woody vegetative material no greater than 6 inches in diameter. This term does not include stumps, roots or shrubs with intact root balls.

**SECTION 2.** Section 8-3-13 (l)(1)(a) and (d), 8-3-13(m)(1)(a) and 8-3-13(m)(2) of the Code of Ordinances of the City of Cedarburg is hereby amended as follows:

(l) *Responsibilities of owners or designated agents of multi-family dwellings.*

- (1) Owners or designated agents of multi-family dwellings shall do all of the following to recycle the materials specified in section 8-3-13(g)(5-15):
  - a. Provide adequate, separate containers for the recycling program established in compliance with the ordinance. The number of recycling containers shall equal or be greater than the number of trash containers and at least one of the following shall be met:
    - 1) The minimum total volume of recycling container space is equal to 20 gallons per week per dwelling unit.
    - 2) The ratio of trash container volume to recycling container volume is at most 2:1.

- 3) An alternative method that does not result in the overflow of a recycling container during the time period between collection of materials and delivery to a recycling facility..
  - d. Notify tenants of reasons to reduce and recycle solid waste, which materials are collected, how to prepare materials in order to meet the processing requirements, collection methods or sites, locations and hours of operation of drop off collection sites to recycle materials not collected on-site.
- (m) *Responsibilities of owners or designated agent of non-residential facilities and properties.*
- (1) Owners or designated agents of non-residential facilities and properties shall do all of the following to recycle the materials specified in section 8-3-13(g)(5-15):
    - a. Provide adequate, separate containers for the recycling program established under this section. The total volume of recycling containers shall be sufficient to avoid overflow during the time period between collection of materials and delivery to a recycling facility.
  - (2) The requirements specified in (1) do not apply to the owners or designated agents of non-residential facilities and properties if the postconsumer waste generated within the facility or property is treated at a processing facility licenses by the Department of Natural Resources that recovers for recycling the materials specified in section 8-3-13(g)(5-15) from solid waste in as pure a form as is technically feasible.

**SECTION 3.** Severability. If any provision of this ordinance is invalid or unconstitutional, such invalidity or unconstitutionality shall not affect the other provisions of this ordinance.

**SECTION 4.** Effective Date: This ordinance shall take effect and be in force from and after its passage and publication as provided by law.

Passed and adopted this 23<sup>rd</sup> day of February, 2026.

\_\_\_\_\_  
Patricia Thome, Mayor

Attest:

Approved as to form:

\_\_\_\_\_  
Tracie Sette, City Clerk

\_\_\_\_\_  
Michael P. Herbrand, City Attorney

**CITY OF CEDARBURG**

**MEETING DATE:** February 12, 2026

**ITEM NO:** C.

**TITLE:**

Review bids received for the South Washington Avenue Reconstruction Project.

**ISSUE SUMMARY:**

The South Washington Avenue Reconstruction Project is scheduled to take place on Washington Avenue from approximately 150 feet north of Lincoln Boulevard to the City limits south of Pioneer Road.

A total of 6 bids were received with the low bid of \$3,293,003.20 being submitted by Vinton Construction Company. Vinton's low bid was about \$1,350,000 below the engineer's estimate and within budget. The second-place bid was \$391,000 higher than Vinton's bid.

Due to time constraints to get the project started, this item will be taken to the Common Council at their February 9th meeting. This item is for informational purposes only.

**STAFF RECOMMENDATION:**

**BOARD, COMMISSION OR COMMITTEE RECOMMENDATION:**

**BUDGETARY IMPACT:**

**ATTACHMENTS:**

1. Bid Tab

**INITIATED/REQUESTED BY:**

Mike Wieser

**FOR MORE INFORMATION CONTACT:**

SOUTH WASHINGTON AVENUE RECONSTRUCTION PROJECT - BID TAB

BASE BID

Item #	Item Description	Units	Quantity	Vinton Construction Company		Dorner Inc.		PTS Contractors, Inc		LaLonde Contractors, Inc.		Super Western, Inc.		Zignego Company, Inc.	
				Unit Price	Extension	Unit Price	Extension	Unit Price	Extension	Unit Price	Extension	Unit Price	Extension	Unit Price	Extension
1	Paving Mobilizations	EA	3	\$9,900.00	\$29,700.00	\$10,452.00	\$31,356.00	\$10,475.00	\$31,425.00	\$83,858.20	\$251,574.60	\$11,900.00	\$35,700.00	\$5,500.00	\$16,500.00
2	Traffic Control	LS	1	\$137,000.00	\$137,000.00	\$202,381.00	\$202,381.00	\$147,965.95	\$147,965.95	\$56,225.00	\$56,225.00	\$83,232.55	\$83,232.55	\$277,250.00	\$277,250.00
3	Common Excavation	CY	12600	\$20.16	\$254,016.00	\$21.28	\$268,128.00	\$21.30	\$268,380.00	\$25.94	\$326,844.00	\$33.17	\$417,942.00	\$33.00	\$415,800.00
4	Geogrid	SY	27100	\$1.31	\$35,501.00	\$1.38	\$37,398.00	\$1.40	\$37,940.00	\$1.98	\$53,658.00	\$2.64	\$71,544.00	\$2.00	\$54,200.00
5	1 1/4" Dense Graded Base Course	TON	15750	\$12.00	\$189,000.00	\$16.49	\$259,717.50	\$16.50	\$259,875.00	\$23.30	\$366,975.00	\$23.23	\$365,872.50	\$24.00	\$378,000.00
6	Finish Grading	SY	26100	\$0.02	\$522.00	\$0.02	\$522.00	\$0.02	\$522.00	\$0.02	\$522.00	\$1.38	\$36,018.00	\$2.00	\$52,200.00
7	Hot Mix Asphalt Pavement (4 MT 58-28S)	TON	3000	\$65.50	\$196,500.00	\$69.15	\$207,450.00	\$69.30	\$207,900.00	\$65.50	\$196,500.00	\$65.50	\$196,500.00	\$69.05	\$207,150.00
8	Hot Mix Asphalt Pavement (3 MT 58-28S)	TON	6000	\$63.50	\$381,000.00	\$67.04	\$402,240.00	\$67.20	\$403,200.00	\$63.50	\$381,000.00	\$63.50	\$381,000.00	\$62.10	\$372,600.00
9	Tack Coat	GAL	1690	\$3.00	\$5,070.00	\$3.17	\$5,357.30	\$3.15	\$5,323.50	\$3.00	\$5,070.00	\$3.00	\$5,070.00	\$2.25	\$3,802.50
10	24" Concrete Curb & Gutter Remove and Replace	LF	8700	\$20.01	\$174,087.00	\$18.50	\$160,950.00	\$19.70	\$171,390.00	\$30.65	\$266,655.00	\$26.23	\$228,201.00	\$45.18	\$393,066.00
11	6" Concrete Curb	LF	25	\$42.53	\$1,063.25	\$37.00	\$925.00	\$30.10	\$752.50	\$54.33	\$1,358.25	\$42.53	\$1,063.25	\$100.00	\$2,500.00
12	Concrete Island	SF	125	\$21.07	\$2,633.75	\$16.60	\$2,075.00	\$28.40	\$3,550.00	\$23.62	\$2,952.50	\$21.07	\$2,633.75	\$20.00	\$2,500.00
13	5" Concrete Sidewalk Remove & Replace	SF	6500	\$10.58	\$68,770.00	\$8.10	\$52,650.00	\$8.30	\$53,950.00	\$11.53	\$74,945.00	\$11.88	\$77,220.00	\$13.10	\$85,150.00
14	7" Concrete Sidewalk/Driveway Remove & Replace	SF	16100	\$8.37	\$134,757.00	\$8.60	\$138,460.00	\$8.40	\$135,240.00	\$13.24	\$213,164.00	\$9.97	\$160,517.00	\$14.86	\$239,246.00
15	Curb Ramp Detectable Warning Field (24"x60")	EA	19	\$273.66	\$5,199.54	\$396.00	\$7,524.00	\$370.00	\$7,030.00	\$409.50	\$7,780.50	\$273.66	\$5,199.54	\$500.00	\$9,500.00
16	Curb Ramp Detectable Warning Field (24"x96")	EA	3	\$437.86	\$1,313.58	\$528.00	\$1,584.00	\$555.00	\$1,665.00	\$574.50	\$1,723.50	\$437.86	\$1,313.58	\$1,000.00	\$3,000.00
17	Sawing Pavement	LF	475	\$4.00	\$1,900.00	\$10.00	\$4,750.00	\$5.00	\$2,375.00	\$2.25	\$1,068.75	\$5.00	\$2,375.00	\$1.50	\$712.50
18	Pavement Marking, Arrows, Epoxy	EA	11	\$383.00	\$4,213.00	\$90.00	\$990.00	\$90.00	\$990.00	\$85.00	\$935.00	\$85.00	\$935.00	\$383.00	\$4,213.00
19	Pavement Marking, Words, Epoxy	EA	3	\$388.00	\$1,164.00	\$132.00	\$396.00	\$132.00	\$396.00	\$125.00	\$375.00	\$125.00	\$375.00	\$388.00	\$1,164.00
20	Pavement Marking, Yield Line, Epoxy	EA	49	\$38.50	\$1,886.50	\$20.00	\$980.00	\$20.50	\$1,004.50	\$19.35	\$948.15	\$19.35	\$948.15	\$38.50	\$1,886.50
21	Pavement Marking, 4" Epoxy	LF	10371	\$0.65	\$6,741.15	\$2.30	\$23,853.30	\$2.30	\$23,853.30	\$2.15	\$22,297.65	\$2.15	\$22,297.65	\$0.65	\$6,741.15
22	Pavement Marking, 8" Epoxy	LF	74	\$2.00	\$148.00	\$4.50	\$333.00	\$4.60	\$340.40	\$4.30	\$318.20	\$4.30	\$318.20	\$2.00	\$148.00
23	Pavement Marking, 18" Epoxy	LF	207	\$16.10	\$3,332.70	\$10.20	\$2,111.40	\$10.20	\$2,111.40	\$9.65	\$1,997.55	\$9.65	\$1,997.55	\$16.10	\$3,332.70
24	Pavement Marking, 24" Epoxy	LF	1101	\$22.00	\$24,222.00	\$13.70	\$15,083.70	\$13.70	\$15,083.70	\$12.95	\$14,257.95	\$12.95	\$14,257.95	\$22.00	\$24,222.00
25	Dust Control	LS	1	\$2,000.00	\$2,000.00	\$5,000.00	\$5,000.00	\$6,790.00	\$6,790.00	\$5,120.00	\$5,120.00	\$20,000.00	\$20,000.00	\$1.00	\$1.00
26	Type C Inlet Protection	EA	44	\$70.00	\$3,080.00	\$100.00	\$4,400.00	\$69.00	\$3,036.00	\$65.00	\$2,860.00	\$75.00	\$3,300.00	\$35.00	\$1,540.00
27	Restoration (Hydroseed)	SY	10000	\$6.95	\$69,500.00	\$5.00	\$50,000.00	\$6.70	\$67,000.00	\$6.30	\$63,000.00	\$11.00	\$110,000.00	\$1.29	\$12,900.00
28	4" Underdrain	LF	200	\$18.69	\$3,738.00	\$69.00	\$13,800.00	\$32.00	\$6,400.00	\$69.00	\$13,800.00	\$16.00	\$3,200.00	\$69.00	\$13,800.00
29	12" RCP Storm Sewer Pipe CL V w/ Granular Backfill	LF	675	\$76.31	\$51,509.25	\$149.00	\$100,575.00	\$177.00	\$119,475.00	\$149.00	\$100,575.00	\$141.00	\$95,175.00	\$149.00	\$100,575.00
30	15" RCP Storm Sewer Pipe CL IV w/ Granular Backfill	LF	60	\$83.66	\$5,019.60	\$122.00	\$7,320.00	\$203.00	\$12,180.00	\$122.00	\$7,320.00	\$165.00	\$9,900.00	\$122.00	\$7,320.00
31	24" RCP Storm Sewer Pipe CL III w/ Granular Backfill	LF	150	\$107.15	\$16,072.50	\$140.00	\$21,000.00	\$203.00	\$30,450.00	\$140.00	\$21,000.00	\$180.00	\$27,000.00	\$140.00	\$21,000.00
32	27" RCP Storm Sewer Pipe CL III w/ Granular Backfill	LF	50	\$145.45	\$7,272.50	\$160.00	\$8,000.00	\$230.00	\$11,500.00	\$160.00	\$8,000.00	\$190.00	\$9,500.00	\$160.00	\$8,000.00
33	24" x 36" Catch Basin with Casting	EA	36	\$3,824.56	\$137,684.16	\$4,980.00	\$179,280.00	\$3,855.00	\$138,780.00	\$4,980.00	\$179,280.00	\$2,600.00	\$93,600.00	\$4,980.00	\$179,280.00
34	60" Conflict Manhole with Casting	EA	2	\$10,813.50	\$21,627.00	\$12,506.00	\$25,012.00	\$10,895.00	\$21,790.00	\$12,506.00	\$25,012.00	\$7,800.00	\$15,600.00	\$12,506.00	\$25,012.00
35	48" Storm Manhole with Casting	EA	5	\$6,883.10	\$34,415.50	\$5,467.00	\$27,335.00	\$3,730.00	\$18,650.00	\$5,467.00	\$27,335.00	\$3,500.00	\$17,500.00	\$5,467.00	\$27,335.00
36	60" Storm Manhole with Casting	EA	4	\$8,698.63	\$34,794.52	\$7,177.00	\$28,708.00	\$10,065.00	\$40,260.00	\$7,177.00	\$28,708.00	\$5,000.00	\$20,000.00	\$7,177.00	\$28,708.00
37	72" Storm Manhole with Casting	EA	2	\$11,244.75	\$22,489.50	\$9,438.00	\$18,876.00	\$12,085.00	\$24,170.00	\$9,438.00	\$18,876.00	\$7,500.00	\$15,000.00	\$9,438.00	\$18,876.00
38	6" PVC C900 Class 150 Watermain Relay w/ Granular Backfill	LF	103	\$119.74	\$12,333.22	\$144.00	\$14,832.00	\$180.00	\$18,540.00	\$144.00	\$14,832.00	\$210.00	\$21,630.00	\$144.00	\$14,832.00
39	8" PVC C900 Class 150 Watermain Relay w/ Granular Backfill	LF	404	\$169.53	\$68,490.12	\$184.00	\$74,336.00	\$200.00	\$80,800.00	\$184.00	\$74,336.00	\$210.00	\$84,840.00	\$184.00	\$74,336.00
40	8" Gate Valve & Valve Box	EA	2	\$2,863.50	\$5,727.00	\$3,046.00	\$6,092.00	\$2,800.00	\$5,600.00	\$3,046.00	\$6,092.00	\$3,000.00	\$6,000.00	\$3,046.00	\$6,092.00
41	8" Gate Valve, Box, Wet Tap and Tee	EA	2	\$6,056.25	\$12,112.50	\$7,278.00	\$14,556.00	\$8,060.00	\$16,120.00	\$7,278.00	\$14,556.00	\$10,000.00	\$20,000.00	\$7,278.00	\$14,556.00
42	6" Gate Valve, Box, Wet Tap and Tee	EA	2	\$4,936.75	\$9,873.50	\$3,610.00	\$7,220.00	\$7,220.00	\$14,440.00	\$3,610.00	\$7,220.00	\$9,000.00	\$18,000.00	\$3,610.00	\$7,220.00
43	Hydrant Assembly (Hydrant, Lead, Valve, fittings)	EA	4	\$8,392.94	\$33,571.76	\$14,978.00	\$59,912.00	\$8,250.00	\$33,000.00	\$14,978.00	\$59,912.00	\$10,000.00	\$40,000.00	\$14,978.00	\$59,912.00
44	Remove Existing Manhole and Replace with Valve Box	EA	2	\$2,913.75	\$5,827.50	\$2,963.00	\$5,926.00	\$1,855.00	\$3,710.00	\$2,963.00	\$5,926.00	\$2,000.00	\$4,000.00	\$2,963.00	\$5,926.00
45	1 1/2" HDPE Water Service Relay w/ Granular Backfill (Includes Fittings)	LF	574	\$98.55	\$56,567.70	\$125.00	\$71,750.00	\$181.00	\$103,894.00	\$125.00	\$71,750.00	\$170.00	\$97,580.00	\$125.00	\$71,750.00
46	2" Thick, 24" Wide Foam Insulation	LF	200	\$7.75	\$1,550.00	\$10.00	\$2,000.00	\$6.00	\$1,200.00	\$10.00	\$2,000.00	\$10.00	\$2,000.00	\$10.00	\$2,000.00
47	8" PVC SDR 35 Sanitary Sewer Relay w/ Granular Backfill	LF	2745	\$132.76	\$364,426.20	\$150.00	\$411,750.00	\$209.00	\$573,705.00	\$150.00	\$411,750.00	\$218.00	\$598,410.00	\$150.00	\$411,750.00
48	6" PVC SDR 35 Sanitary Lateral Relay w/ Granular Backfill	LF	250	\$222.51	\$55,627.50	\$150.00	\$37,500.00	\$225.00	\$56,250.00	\$150.00	\$37,500.00	\$240.00	\$60,000.00	\$150.00	\$37,500.00
49	6" Sanitary Lateral Reconnect	EA	19	\$1,337.37	\$25,410.03	\$943.00	\$17,917.00	\$455.00	\$8,645.00	\$943.00	\$17,917.00	\$200.00	\$3,800.00	\$943.00	\$17,917.00
50	48" Sanitary Manhole w/ Casting & Internal/External Seal	EA	18	\$6,552.03	\$117,936.54	\$6,921.00	\$124,578.00	\$7,070.00	\$127,260.00	\$6,921.00	\$124,578.00	\$5,500.00	\$99,000.00	\$6,921.00	\$124,578.00
51	48" Sanitary Manhole w/ Casting & Internal/External Seal (Outside Drop)	EA	1	\$10,046.50	\$10,046.50	\$10,154.00	\$10,154.00	\$10,805.00	\$10,805.00	\$10,154.00	\$10,154.00	\$8,100.00	\$8,100.00	\$10,154.00	\$10,154.00
52	Rock Excavation	CY	100	\$50.00	\$5,000.00	\$100.00	\$10,000.00	\$235.00	\$23,500.00	\$100.00	\$10,000.00	\$75.00	\$7,500.00	\$100.00	\$10,000.00
53	Existing Storm Structure Chimney Repair with Casting	EA	12	\$1,374.50	\$16,494.00	\$2,406.00	\$28,872.00	\$1,915.00	\$22,980.00	\$2,406.00	\$28,872.00	\$1,800.00	\$21,600.00	\$2,406.00	\$28,872.00
54	Removing Traffic Signals (Washington Ave & CTH C)	EACH	1	\$4,224.00	\$4,224.00	\$4,459.00	\$4,459.00	\$34,395.00	\$34,395.00	\$4,224.00	\$4,224.00	\$15,000.00	\$15,000.00	\$4,224.00	\$4,224.00
55	Removing Traffic Signals (Washington Ave & Lincoln Blvd)	EACH	1	\$4,224.00	\$4,224.00	\$4,459.00	\$4,459.00	\$34,395.00	\$34,395.00	\$4,224.00	\$4,224.00	\$15,000.00	\$15,000.00	\$4,224.00	\$4,224.00
56	Removing Concrete Bases	EACH	18	\$250.00	\$4,500.00	\$370.00	\$6,660.00	\$210.00	\$3,780.00	\$350.00	\$6,300.00	\$600.00	\$10,800.00	\$500.00	\$9,000.00

Item #	Item Description	Units	Quantity	Vinton Construction Company		Dorner Inc.		PTS Contractors, Inc		LaLonde Contractors, Inc.		Super Western, Inc.		Zignego Company, Inc.	
				Unit Price	Extension	Unit Price	Extension	Unit Price	Extension	Unit Price	Extension	Unit Price	Extension	Unit Price	Extension
57	Base Aggregate Dense 1 1/4-Inch	TON	65	\$20.00	\$1,300.00	\$21.12	\$1,372.80	\$21.00	\$1,365.00	\$31.70	\$2,060.50	\$100.00	\$6,500.00	\$100.00	\$6,500.00
58	Concrete Sidewalk 5-Inch	SF	1700	\$7.91	\$13,447.00	\$7.00	\$11,900.00	\$7.25	\$12,325.00	\$15.58	\$26,486.00	\$7.91	\$13,447.00	\$20.00	\$34,000.00
59	Conduit Rigid Nonmetallic Schedule 40 2-Inch	LF	232	\$7.40	\$1,716.80	\$7.80	\$1,809.60	\$14.80	\$3,433.60	\$7.40	\$1,716.80	\$8.00	\$1,856.00	\$7.40	\$1,716.80
60	Conduit Rigid Nonmetallic Schedule 40 3-Inch	LF	1732	\$8.30	\$14,375.60	\$8.80	\$15,241.60	\$16.90	\$29,270.80	\$8.30	\$14,375.60	\$8.30	\$14,375.60	\$8.30	\$14,375.60
61	Pull Boxes Steel 24x42-Inch	EACH	20	\$1,115.00	\$22,300.00	\$1,177.00	\$23,540.00	\$2,380.00	\$47,600.00	\$1,115.00	\$22,300.00	\$1,115.00	\$22,300.00	\$1,115.00	\$22,300.00
62	Removing Pull Boxes	EACH	31	\$74.00	\$2,294.00	\$78.00	\$2,418.00	\$105.00	\$3,255.00	\$74.00	\$2,294.00	\$74.00	\$2,294.00	\$74.00	\$2,294.00
63	Concrete Bases Type 1	EACH	7	\$923.00	\$6,461.00	\$974.00	\$6,818.00	\$2,065.00	\$14,455.00	\$923.00	\$6,461.00	\$923.00	\$6,461.00	\$923.00	\$6,461.00
64	Concrete Bases Type 2	EACH	8	\$1,152.00	\$9,216.00	\$1,216.00	\$9,728.00	\$2,275.00	\$18,200.00	\$1,152.00	\$9,216.00	\$1,152.00	\$9,216.00	\$1,152.00	\$9,216.00
65	Concrete Control Cabinet Bases Type 9 Special	EACH	2	\$2,711.00	\$5,422.00	\$2,862.00	\$5,724.00	\$2,960.00	\$5,920.00	\$2,711.00	\$5,422.00	\$2,711.00	\$5,422.00	\$2,711.00	\$5,422.00
66	Electrical Wire Traffic Signals 10 AWG	LF	3103	\$1.11	\$3,444.33	\$1.20	\$3,723.60	\$1.05	\$3,258.15	\$1.11	\$3,444.33	\$1.11	\$3,444.33	\$1.11	\$3,444.33
67	Traffic Signal EVP Detector Cable	LF	1717	\$1.32	\$2,266.44	\$1.40	\$2,403.80	\$2.10	\$3,605.70	\$1.32	\$2,266.44	\$1.32	\$2,266.44	\$1.32	\$2,266.44
68	Cable Traffic Signal 5-14 AWG	LF	873	\$1.80	\$1,571.40	\$1.90	\$1,658.70	\$2.00	\$1,746.00	\$1.80	\$1,571.40	\$1.80	\$1,571.40	\$1.80	\$1,571.40
69	Cable Traffic Signal 7-14 AWG	LF	296	\$2.20	\$651.20	\$2.30	\$680.80	\$2.30	\$680.80	\$2.20	\$651.20	\$2.20	\$651.20	\$2.20	\$651.20
70	Cable Traffic Signal 9-14 AWG	LF	1098	\$2.76	\$3,030.48	\$2.90	\$3,184.20	\$3.45	\$3,788.10	\$2.76	\$3,030.48	\$2.76	\$3,030.48	\$2.76	\$3,030.48
71	Cable Traffic Signal 12-14 AWG	LF	1752	\$3.43	\$6,009.36	\$3.60	\$6,307.20	\$4.00	\$7,008.00	\$3.43	\$6,009.36	\$3.43	\$6,009.36	\$3.43	\$6,009.36
72	Cable Traffic Signal 15-14 AWG	LF	952	\$4.56	\$4,341.12	\$4.80	\$4,569.60	\$5.30	\$5,045.60	\$4.56	\$4,341.12	\$4.56	\$4,341.12	\$4.56	\$4,341.12
73	Electrical Service Meter Breaker Pedestal (Washington Ave & Lincoln Blvd)	EACH	1	\$1,844.00	\$1,844.00	\$1,947.00	\$1,947.00	\$2,325.00	\$2,325.00	\$1,844.00	\$1,844.00	\$1,844.00	\$1,844.00	\$1,844.00	\$1,844.00
74	Pedestal Bases	EACH	7	\$244.00	\$1,708.00	\$258.00	\$1,806.00	\$365.00	\$2,555.00	\$244.00	\$1,708.00	\$244.00	\$1,708.00	\$244.00	\$1,708.00
75	Transformer Bases Breakaway 11 1/2-Inch Bolt Circle	EACH	4	\$595.00	\$2,380.00	\$628.00	\$2,512.00	\$715.00	\$2,860.00	\$595.00	\$2,380.00	\$595.00	\$2,380.00	\$595.00	\$2,380.00
76	Poles Type 2	EACH	4	\$2,275.00	\$9,100.00	\$2,402.00	\$9,608.00	\$2,430.00	\$9,720.00	\$2,275.00	\$9,100.00	\$2,275.00	\$9,100.00	\$2,275.00	\$9,100.00
77	Traffic Signal Standards Aluminum 13-FT	EACH	2	\$545.00	\$1,090.00	\$575.00	\$1,150.00	\$605.00	\$1,210.00	\$545.00	\$1,090.00	\$545.00	\$1,090.00	\$545.00	\$1,090.00
78	Traffic Signal Standards Aluminum 15-FT	EACH	2	\$606.00	\$1,212.00	\$640.00	\$1,280.00	\$665.00	\$1,330.00	\$606.00	\$1,212.00	\$606.00	\$1,212.00	\$606.00	\$1,212.00
79	Traffic Signal Standards Aluminum 10-FT	EACH	3	\$496.00	\$1,488.00	\$524.00	\$1,572.00	\$550.00	\$1,650.00	\$496.00	\$1,488.00	\$496.00	\$1,488.00	\$496.00	\$1,488.00
80	Trombone Arms 25-FT	EACH	4	\$2,026.00	\$8,104.00	\$2,139.00	\$8,556.00	\$2,430.00	\$9,720.00	\$2,026.00	\$8,104.00	\$2,026.00	\$8,104.00	\$2,026.00	\$8,104.00
81	Traffic Signal Face 3S 12-Inch	EACH	20	\$863.20	\$17,264.00	\$911.00	\$18,220.00	\$910.00	\$18,200.00	\$863.20	\$17,264.00	\$863.00	\$17,260.00	\$863.20	\$17,264.00
82	Traffic Signal Face 4S 12-Inch	EACH	4	\$1,164.60	\$4,658.40	\$1,230.00	\$4,920.00	\$1,125.00	\$4,500.00	\$1,164.60	\$4,658.40	\$1,164.60	\$4,658.40	\$1,164.60	\$4,658.40
83	Traffic Signal Face 5S 12-Inch	EACH	4	\$1,472.00	\$5,888.00	\$1,554.00	\$6,216.00	\$1,480.00	\$5,920.00	\$1,472.00	\$5,888.00	\$1,472.00	\$5,888.00	\$1,472.00	\$5,888.00
84	Pedestrian Signal Face 16-Inch	EACH	16	\$595.00	\$9,520.00	\$628.00	\$10,048.00	\$660.00	\$10,560.00	\$595.00	\$9,520.00	\$595.00	\$9,520.00	\$595.00	\$9,520.00
85	Signal Mounting Hardware (Washington Ave & CTH C)	EACH	1	\$3,225.00	\$3,225.00	\$3,405.00	\$3,405.00	\$4,100.00	\$4,100.00	\$3,225.00	\$3,225.00	\$3,225.00	\$3,225.00	\$3,225.00	\$3,225.00
86	Signal Mounting Hardware (Washington Ave & Lincoln Blvd)	EACH	1	\$5,522.00	\$5,522.00	\$5,830.00	\$5,830.00	\$6,245.00	\$6,245.00	\$5,522.00	\$5,522.00	\$5,522.00	\$5,522.00	\$5,522.00	\$5,522.00
87	Lamp, Ballast, LED, Switch Disposal by Contractor	EACH	40	\$1.70	\$68.00	\$2.00	\$80.00	\$79.00	\$3,160.00	\$1.70	\$68.00	\$1.70	\$68.00	\$1.70	\$68.00
88	01. Transformer Bases Breakaway 11 1/2-Inch Bolt Circle Black	EACH	4	\$658.00	\$2,632.00	\$695.00	\$2,780.00	\$805.00	\$3,220.00	\$658.00	\$2,632.00	\$658.00	\$2,632.00	\$658.00	\$2,632.00
89	02. Poles Type 2 Black	EACH	4	\$2,599.00	\$10,396.00	\$2,744.00	\$10,976.00	\$2,785.00	\$11,140.00	\$2,599.00	\$10,396.00	\$2,599.00	\$10,396.00	\$2,599.00	\$10,396.00
90	03. Trombone Arms 20-FT Black	EACH	2	\$2,078.00	\$4,156.00	\$2,194.00	\$4,388.00	\$2,530.00	\$5,060.00	\$2,078.00	\$4,156.00	\$2,078.00	\$4,156.00	\$2,078.00	\$4,156.00
91	04. Trombone Arms 25-FT Black	EACH	2	\$2,495.00	\$4,990.00	\$2,634.00	\$5,268.00	\$2,955.00	\$5,910.00	\$2,495.00	\$4,990.00	\$2,495.00	\$4,990.00	\$2,495.00	\$4,990.00
92	05. Emergency Vehicle Preemption System with LED Confirmation Lights, Washington Ave & CTH C	EACH	1	\$6,867.00	\$6,867.00	\$7,250.00	\$7,250.00	\$8,595.00	\$8,595.00	\$6,867.00	\$6,867.00	\$6,867.00	\$6,867.00	\$6,867.00	\$6,867.00
93	06. Emergency Vehicle Preemption System with LED Confirmation Lights, Washington Ave & Lincoln Blvd	EACH	1	\$6,867.00	\$6,867.00	\$7,250.00	\$7,250.00	\$8,595.00	\$8,595.00	\$6,867.00	\$6,867.00	\$6,867.00	\$6,867.00	\$6,867.00	\$6,867.00
94	07. APS Push Button System 8 Buttons, Washington Ave & CTH C	EACH	1	\$9,402.00	\$9,402.00	\$9,926.00	\$9,926.00	\$13,225.00	\$13,225.00	\$9,402.00	\$9,402.00	\$9,402.00	\$9,402.00	\$9,402.00	\$9,402.00
95	08. APS Push Button System 8 Buttons, Washington Ave & Lincoln Blvd	EACH	1	\$9,402.00	\$9,402.00	\$9,926.00	\$9,926.00	\$13,225.00	\$13,225.00	\$9,402.00	\$9,402.00	\$9,402.00	\$9,402.00	\$9,402.00	\$9,402.00
96	09. Traffic Signal Cabinet and Controller, Washington Ave & CTH C	EACH	1	\$27,652.00	\$27,652.00	\$29,194.00	\$29,194.00	\$27,515.00	\$27,515.00	\$27,652.00	\$27,652.00	\$27,652.00	\$27,652.00	\$27,652.00	\$27,652.00
97	10. Traffic Signal Cabinet and Controller Black, Washington Ave & Lincoln Blvd	EACH	1	\$27,199.00	\$27,199.00	\$28,715.00	\$28,715.00	\$27,250.00	\$27,250.00	\$27,199.00	\$27,199.00	\$27,199.00	\$27,199.00	\$27,199.00	\$27,199.00
98	11. Video Detection System, Washington Ave & CTH C	EACH	1	\$37,651.00	\$37,651.00	\$39,750.00	\$39,750.00	\$46,735.00	\$46,735.00	\$37,651.00	\$37,651.00	\$37,651.00	\$37,651.00	\$37,651.00	\$37,651.00
99	12. Video Detection System, Washington Ave & Lincoln Blvd	EACH	1	\$37,651.00	\$37,651.00	\$39,750.00	\$39,750.00	\$46,735.00	\$46,735.00	\$37,651.00	\$37,651.00	\$37,651.00	\$37,651.00	\$37,651.00	\$37,651.00
100	13. City Decorative Pole 14-FT	EACH	4	\$2,291.00	\$9,164.00	\$2,419.00	\$9,676.00	\$2,325.00	\$9,300.00	\$2,291.00	\$9,164.00	\$2,291.00	\$9,164.00	\$2,291.00	\$9,164.00
101	14. Concrete Base Square Special	EACH	4	\$838.00	\$3,352.00	\$885.00	\$3,540.00	\$2,325.00	\$9,300.00	\$838.00	\$3,352.00	\$838.00	\$3,352.00	\$838.00	\$3,352.00
102	20. Rectangular Rapid Flashing Beacon System, Washington Ave & Layton St	EACH	1	\$13,200.00	\$13,200.00	\$18,027.00	\$18,027.00	\$19,570.00	\$19,570.00	\$17,075.00	\$17,075.00	\$17,075.00	\$17,075.00	\$17,075.00	\$17,075.00
103	21. Rectangular Rapid Flashing Beacon System, Washington Ave & Fairfield St	EACH	1	\$13,200.00	\$13,200.00	\$18,027.00	\$18,027.00	\$19,570.00	\$19,570.00	\$17,075.00	\$17,075.00	\$17,075.00	\$17,075.00	\$17,075.00	\$17,075.00
104	01. Colored Concrete Paving, 5" Th. W/ Random Flagstone Stamp Pattern	SF	1700	\$9.07	\$15,419.00	\$19.00	\$32,300.00	\$14.20	\$24,140.00	\$3.83	\$6,511.00	\$8.77	\$14,909.00	\$20.00	\$34,000.00

Vinton Construction Company	Dorner Inc.	PTS Contractors, Inc	LaLonde Contractors, Inc.	Super Western, Inc.	Zignego Company, Inc.
Total = \$3,293,003.20	Total = \$3,684,467.10	Total = \$3,999,860.00	Total = \$4,084,934.23	Total = \$4,108,260.00	Total = \$4,376,276.48

**SUPPLEMENTAL BID ITEMS**

Item #	Item Description	Units	Quantity	Unit Price	Extension	Unit Price	Extension	Unit Price	Extension	Unit Price	Extension	Unit Price	Extension	Unit Price	Extension
105	Slurry Backfill	CY	1	\$120.00	\$120.00	\$200.00	\$200.00	\$175.00	\$175.00	\$200.00	\$200.00	\$120.00	\$120.00	\$300.00	\$300.00

**CITY OF CEDARBURG**

**MEETING DATE:** February 12, 2026

**ITEM NO:** D.

**TITLE:**

Update on the Water Recycling Center Facility Plan.

**ISSUE SUMMARY:**

The WRC Facility Plan was submitted to the WDNR on January 21st.

**STAFF RECOMMENDATION:**

**BOARD, COMMISSION OR COMMITTEE RECOMMENDATION:**

**BUDGETARY IMPACT:**

**ATTACHMENTS:**

None

**INITIATED/REQUESTED BY:**

Mike Wieser

**FOR MORE INFORMATION CONTACT:**

Influent and Effluent Data      Limits: BOD=10mg/l winter 15mg/l summer, TSS= 3.3mg/l, NH3N= 3.3mg/l, PO4=0.8mg/l, D.O. 6-9su, Chloride=570mg/l  
**December, 2025**

Date	Influent										Effluent										
	Flow MGD	Mx Flow GPM	BOD mg/L	TSS mg/L	TKN mg/L	Phos mg/L	NH3N mg/L	pH SU	Cl- mg/L	Flow MGD	Mx Flow GPM	BOD mg/L	TSS mg/L	NH3-N mg/L	Phos mg/L	DO, Max mg/L	DO, Min mg/L	pH SU	Fecals #/100ml	Cl- mg/L	
01	1.616	2,095	290	470				8.0		1.449	826	3	2	0.021	0.126	8.02	7.81	7.6			
02	1.614	2,085	243	620		5.260	20.480	7.7		1.454	815	3	2	<0.018	0.122	7.91	7.81	7.6			
03	1.578	2,326	330	688		5.570	18.300	7.7		1.456	961	3	3	0.024	0.120	8.05	8.02	7.5			
04	1.548	2,370						7.8		1.460	901					8.05	7.93	7.6			
05	1.584	1,776								1.447	851					8.63	7.89				
06	1.594	1,488								1.446	827					8.01	7.89				
07	1.564	1,903	209	468						1.463	791	3	2	<0.018	0.123	8.14	8.09			495	
08	1.573	1,887	229	456				7.7		1.405	804	3	2	0.020	0.113	8.17	7.85	7.5		495	
09	1.588	2,016	257	434		4.600	16.700	7.7		1.421	863	3	2	0.020	0.127	7.97	7.70	7.6		500	
10	1.585	2,105	288	520	36.90	5.500	17.600	7.8		1.426	877	3	2	<0.018	0.117	7.94	7.90	7.6		490	
11	1.585	2,707						7.8		1.491	961					8.00	7.95	7.6			
12	1.595	1,605								1.358	864					8.09	8.05				
13	1.578	1,979								1.415	807					8.35	8.31				
14	1.575	2,022	297	468						1.472	917	3	3	0.030	0.130	8.41	8.27				
15	1.610	1,896	388	700				7.8		1.541	852	3	3	0.038	0.119	8.33	8.02	7.6			
16	1.633	2,035	303	750		5.595	20.157	7.8		1.510	863	3	3	0.034	0.130	8.07	7.84	7.6			
17	1.626	2,038	414	696		5.249	18.947	7.7		1.447	856	3	3	0.021	0.126	7.93	7.60	7.5			
18	1.819	2,222						7.6		1.682	1,053					8.33	7.66	7.6			
19	1.758	2,195								1.664	943					7.83	7.74				
20	1.750	1,573								1.591	943					8.05	8.02				
21	1.703	2,014	310	542						1.550	906	4	3	0.028	0.140	8.13	7.94				
22	1.738	1,910	376	550				7.7		1.646	931	4	3	0.021	0.147	8.00	7.75	7.5			
23	1.715	1,741	403	752		5.800	18.100	7.7		1.547	930	4	3	0.030	0.358	7.83	7.79	7.6			
24	1.696	1,964	283	486		5.200	16.200	7.6		1.525	906	4	3	0.025	0.153	7.87	7.73	7.5			
25	1.613	2,080						7.7		1.416	954					7.83	7.64	7.6			
26	1.844	1,719								1.700	918					7.72	7.68				
27	1.823	1,468								1.593	1,003					7.75	7.56				
28	2.002	2,998	246	746						1.778	1,149	5	3	0.023	0.144	7.66	7.63				
29	2.055	2,083	227	350				7.7		1.931	1,150	3	3	0.025	0.141	8.02	7.99	7.5			
30	1.972	2,138	358	526		4.169	13.943	7.7		1.858	1,102	4	5	0.125	0.144	8.10	7.74	7.5			
31	1.913	1,723	136	346		3.483	12.620	7.7		1.757	1,103	4	3	0.035	0.150	8.02	7.98	7.5			
Min	1.548	1,468	136	346	36.90	3.48	12.620	7.6		1.358	791	3	2	<0.018	0.113	7.66	7.56	7.5		490	
Max	2.055	2,998	414	752	36.90	5.80	20.480	8.0		1.931	1,150	5	5	0.125	0.358	8.63	8.31	7.6		500	
Total	52.447	62,161	5,585	10,568	36.90	50.43	73.047	146.9		47.899	28,627	66	53	0.574	2.730	249.21	243.78	143.6		1,980	
Avg	1.692	2,005	294	556	36.90	5.04	17.305	7.7		1.545	923	3	3	0.030	0.144	8.04	7.86	7.6		495	
GeoMn																					

### Plant Performance

Bod=Blue TSS=red NH3N=green PO4=Pink

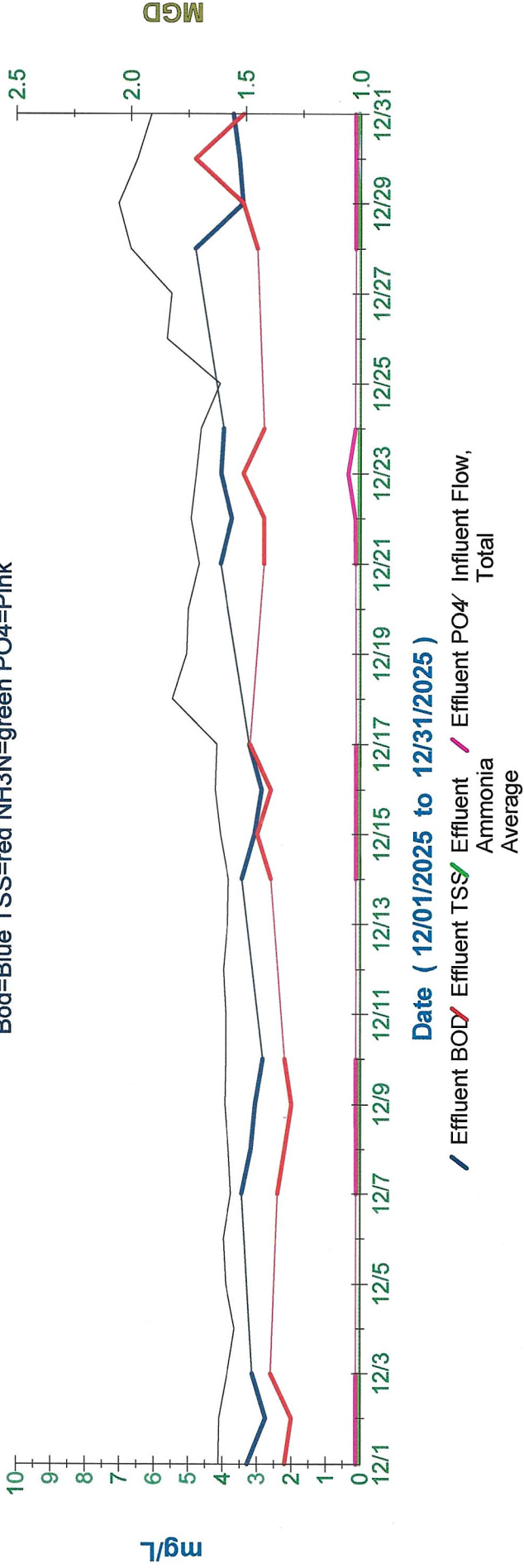

Plant Performance

### Precipitation vs Flow mgd

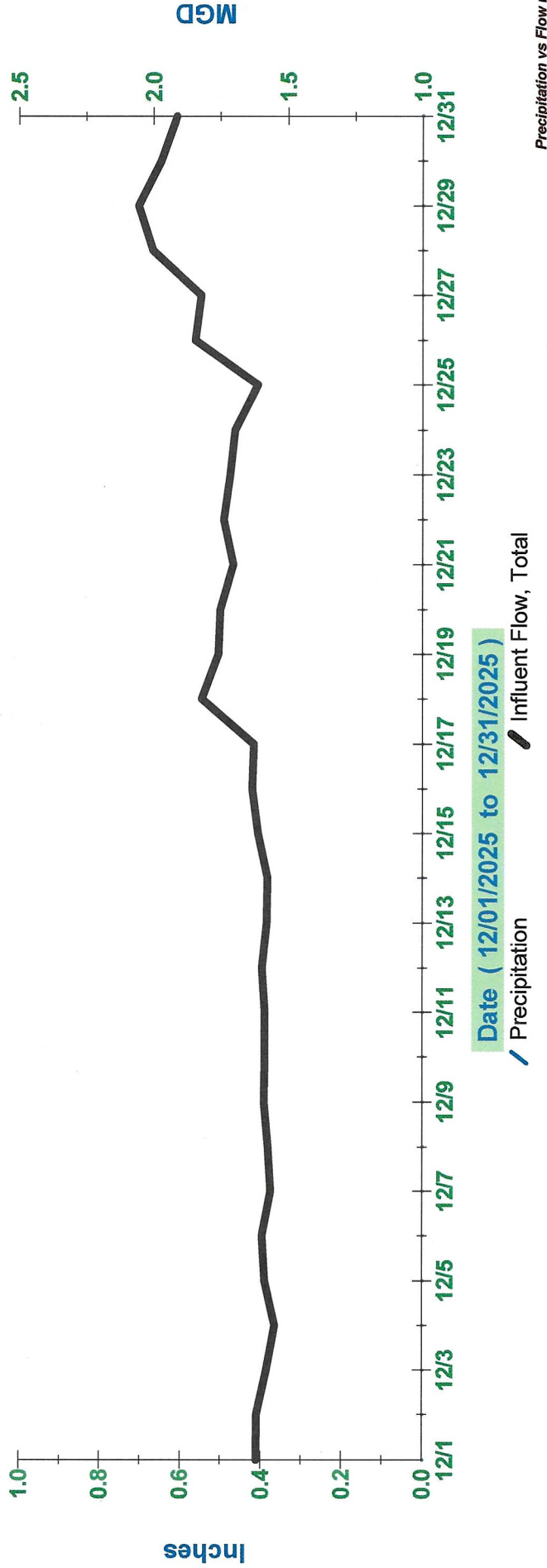

Precipitation vs Flow mgd

Influent and Effluent Data Limits: BOD=10mg/l winter 15mg/l summer, TSS= 15mg/l, NH3N= 3.3mg/l, PO4=0.8mg/l, D.O. 6-9su, Chloride=570mg/l

January, 2026

Date	Influent										Effluent									
	Flow MGD	Mx Flow GPM	BOD mg/L	TSS mg/L	TKN mg/L	Phos mg/L	NH3N mg/L	pH SU	Cl- mg/L	Flow MGD	Mx Flow GPM	BOD mg/L	TSS mg/L	NH3-N mg/L	Phos mg/L	DO, Max mg/L	DO, Mn mg/L	pH SU	Fecals #/100ml	Cl- mg/L
01	1.856	1,820						7.7		1.687	1,061				8.11	7.95	7.6			
02	1.886	2,126							1.704	1,041					8.05	7.90				
03	1.855	2,012							1.647	967					8.03	7.89				
04	1.871	2,186	289	756					1.670	1,017	4	4	0.073	0.709	8.00	7.68				
05	1.829	2,867	273	692				7.7	1.643	1,064	4	3	0.043	0.187	7.75	7.42	7.4			
06	1.967	2,272	433	552		4.600	17.200	7.8	1.790	1,113	5	3	0.074	0.185	7.50	7.42	7.5			
07	1.929	2,161	241	482		4.320	14.10	7.7	1.755	1,101	5	3	0.026	0.174	7.79	7.63	7.5			
08	2.077	2,506						7.8	1.969	1,368					7.71	7.48	7.5			
09	2.227	2,256							2.202	1,295					7.70	7.65				
10	2.290	2,217							2.288	1,394					7.88	7.83				
11	2.237	2,888	165	188					2.187	1,267	5	3	0.030	0.149	7.99	7.88				
12	2.207	2,391	205	230				7.8	2.211	1,234	3	3	0.027	0.151	8.01	7.72	7.6			
13	2.166	2,486	139	144		2.890	17.107	7.8	2.136	1,287	3	3	0.025	0.149	7.79	7.70	7.6			
14	2.090	2,517	129	154		2.749	16.978	7.8	1.997	1,248	3	3	0.024	0.147	8.06	8.02	7.6			
15	2.104	2,121						7.7	2.032	1,297					8.11	7.84	7.5			
16	2.059	2,084							2.004	1,150					7.97	7.94				
17	2.001	1,833							1.918	1,630					8.08	7.93				
18			118	608							3	3	0.026	0.140						
19	1.937	2,193	232	400				7.8	1.821	1,152	4	3	0.029	0.137	8.41	8.38	7.6			
20	1.931	2,290	247	818		5.210	18.100	7.9	1.841	1,102	4	4	0.039	0.143	8.47	8.08	7.6			
21	1.952	2,074	293	810		4.900	18.100	7.7	1.806	1,040	4	3	0.034	0.141	8.17	8.12	7.5			
22	1.916	2,355						7.7	1.778	1,042					8.48	8.42	7.6			
23	1.837	2,100							1.687	1,020					8.64	8.57				
24	1.868	1,980							1.712	1,043					8.68	8.36				
25	1.895	2,655	291	638					1.717	982	4	5	0.047	0.157	8.47	8.40				
26	1.898	2,598	348	788				7.8	1.715	1,006	4	4	0.059	0.154	8.50	8.22	7.5			
27	1.866	2,255	313	616		4.253	20.771	7.8	1.703	1,007	4	4	0.067	0.164	8.34	8.26	7.5			
28	1.844	2,516	216	270		3.844	19.818	7.8	1.687	985	5	5	0.070	0.181	8.34	8.31	7.5			
29	1.833	2,007						7.8	1.641	958					8.40	8.30	7.6			
30	1.818	1,981							1.641	954					8.40	8.34				
31	1.820	1,897							1.638	955					8.44	8.28				
Min	1.818	1,820	118	144		2.75	14.100	7.7	1.638	954	3	3	0.024	0.137	7.50	7.42	7.4			
Max	2.290	2,888	433	818		5.21	20.771	7.9	2.288	1,630	5	5	0.074	0.709	8.68	8.57	7.6			
Total	59.066	67,644	3,930	8,146		32.77	42.174	132.1	55.227	33,780	65	55	0.693	3.068	244.27	239.92	128.1			
Avg	1.969	2,255	246	509		4.10	17.772	7.8	1.841	1,126	4	4	0.043	0.192	8.14	8.00	7.5			
GeoMn																				

### Plant Performance

Bod=Blue TSS=red NH3N=green PO4=Pink

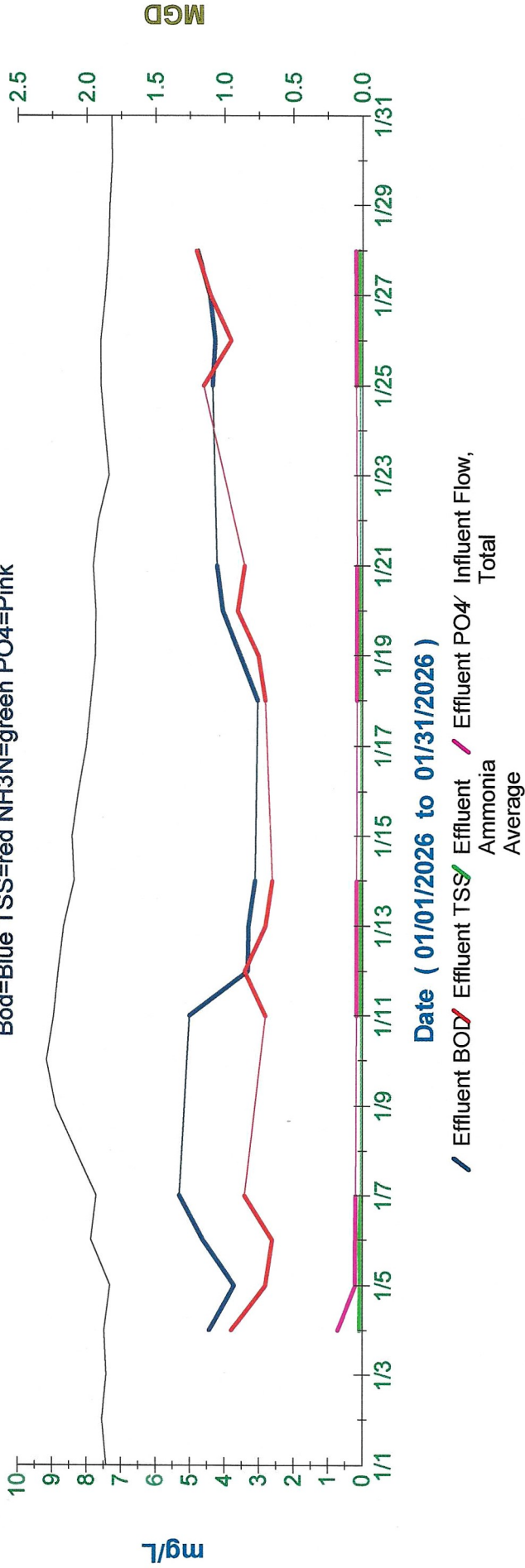

### Precipitation vs Flow mgd

